

# Installation Instructions

**Note:** STR's come with 2 x Rope Grips, 3m of Wire Rope, 1 x 5mm Eye/Eye Turnbuckle, Socket and a 10mm Pig Tail.

## SAFE-T-RIP® TAIL END RIP

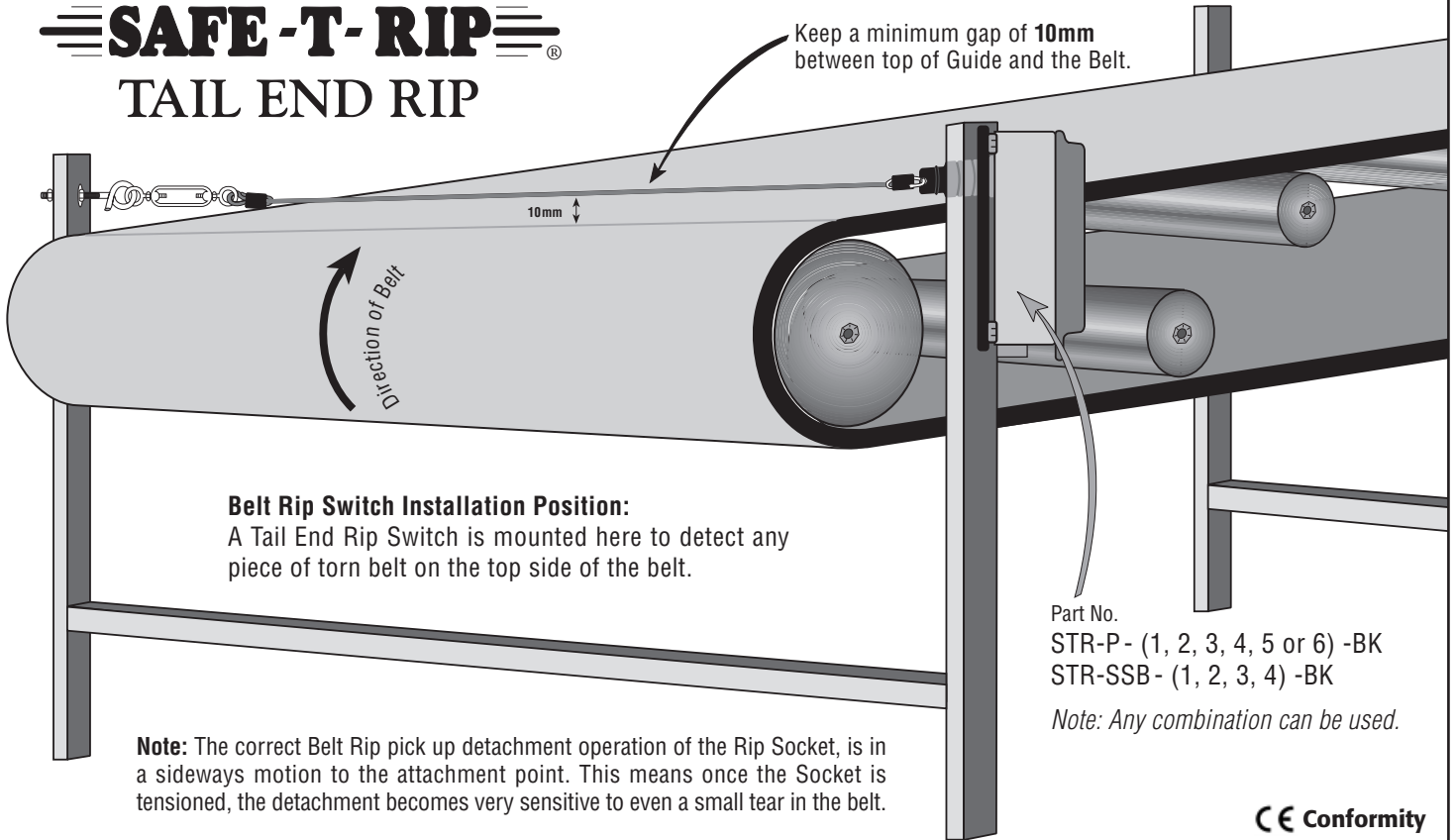

### Belt Rip Switch Installation Position:

A Tail End Rip Switch is mounted here to detect any piece of torn belt on the top side of the belt.

**Note:** The correct Belt Rip pick up detachment operation of the Rip Socket, is in a sideways motion to the attachment point. This means once the Socket is tensioned, the detachment becomes very sensitive to even a small tear in the belt.

Part No.  
STR-P- (1, 2, 3, 4, 5 or 6) -BK  
STR-SSB- (1, 2, 3, 4) -BK

*Note: Any combination can be used.*

CE Conformity

## ORDERING DETAILS and ELECTRICAL DATA

CAT No.	Switch Device	Contact Configuration	Switched Power	Switched Voltage Max.	Switched Current Resistive AC (IMS) Max.	Inductive Loads (Power Factor 0.4)	Typical Application
STR-P-1.....*	Dry Reed Switch	S.P.S.T.	12w	230V AC 230V DC	1A	Not suitable	PLC & Control Circuits
STR-P-2.....*	Dry Reed Switch	S.P.D.T.	5w	175V AC 175V DC	0.25	Not suitable	PLC & Control Circuits
STR-P-3.....*	Dry Reed Switch	2 x S.P.D.T.	5w	175V AC 175V DC	0.25	Not suitable	PLC & Control Circuits
STR-P-4.....*	Micro Switch	1 x S.P.D.T.	N/A	250V AC 250V DC	15A 03.A at 250V DC	10A at 250V AC Control Circuits	General AC or DC
STR-P-5.....*	Micro Switch	2 x S.P.D.T.	N/A	250V AC 250V DC	15A 03.A at 250V DC	10A at 250V AC Control Circuits	General AC or DC
STR-P-6.....*	Micro Switch	3 x S.P.D.T.	N/A	250V AC 250V DC	15A 03.A at 250V DC	10A at 250V AC Control Circuits	General AC or DC