











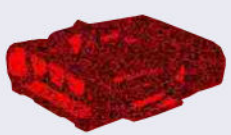

WEATHER PACK SERIES, SEALED CONNECTORS

Weather Pack connectors are made for signal level circuits in harsh environmental conditions where even a small degradation in the connection may be critical. Special materials and seals are used to allow the connector to withstand conditions of extreme temperature, moisture and even submersion. The connector employs a pin and sleeve-type terminal. The pin flexes outward to maintain contact with the sleeve and is therefore called a flexpin. The sleeve has a laplock to reduce relaxation. Rated at up to 20 amps DC, the housings incorporate a positive locking latch and a secondary lock on the contacts. The one (1) to six (6) circuit housings are designed to be used in line or mounted by insertion of a Weather Pack mounting clip. The twenty-two (22) circuit connector is designed to be bulkhead mounted. Male plugs mate with male pins.

WEATHER PACK HOUSINGS

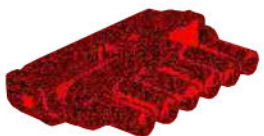
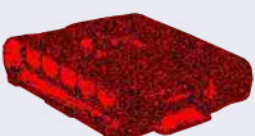
NO. OF CIRCUITS		FEMALE PLUG		MALE PLUG	PACK QTY
1	12015791		12010996		50
2	12015792		12010973		50
3	12015793		12010717		50
4	12015797		12010974		50
4	12015798		12015024		50
5	12034342		12065158		50
6	12015799		12010975		50
22*	12020991		12020005		50

* Both plugs each require 2 secondary locks, part number 12010852.

Note: All prices in catalogue exclude GST.

SALES ENQUIRIES FREE CALL: 1800 777 458



**MALE TERMINAL (PIN)
AND CABLE SEAL**



**FEMALE TERMINAL (SLEEVE)
AND CABLE SEAL**



CAVITY PLUG



**WEATHER PACK CONNECTOR
MOUNTING CLIPS**

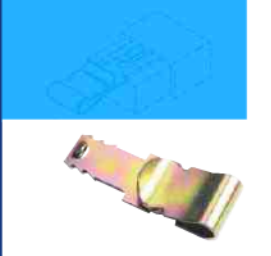

**WEATHER PACK CONNECTOR
MOUNTING CLIPS**



CONTACTS - PINS

PART NO. PIN	WIRE mm2	WIRE AUTO	TRADE PRICE PER PACK	PACK QTY	CODE
					C
12089040L	1	3	\$94.09	100	
12124582L	2	4	\$94.09	100	
12124587L	3	5	\$106.05	100	
12089307L	.35		\$152.79	100	

SOCKETS

PART NO. SOCKET	WIRE mm2	WIRE AUTO	TRADE PRICE PER PACK	PACK QTY	CODE
					C
12089188L	1	3	\$93.41	100	
12124580L	2	4	\$93.97	100	
12124581L	3	5	\$97.00	100	
12020801L	.35		\$123.55	100	

HOUSINGS

PART NO. RECEPT.	POLES	TYPE	LATCH	TRADE PRICE PER PACK	PACK QTY	CODE
						C
12015791	1	FLAT	YES	\$161.62	50	
12015792	2	FLAT	YES	\$156.25	50	
12015793	3	FLAT	YES	\$190.05	50	
12015797	4	FLAT	YES	\$272.27	50	
12015798	4	SQUARE	YES	\$274.97	50	
12034342	5	FLAT	YES	\$565.48	50	
12015799	6	FLAT	YES	\$296.15	50	
12020991	22	ROUND	YES	\$50.25	1	
12010852		SECONDARY LOCK		\$17.68	10	

PART NO. PLUG	POLES	TYPE	LATCH	TRADE PRICE PER PACK	PACK QTY	CODE
						C
12010996	1	FLAT	YES	\$97.13	50	
12010973	2	FLAT	YES	\$107.92	50	
12010717	3	FLAT	YES	\$125.48	50	
12010974	4	FLAT	YES	\$131.49	50	
12015024	4	SQUARE	YES	\$286.43	50	
12065158	5	FLAT	YES	\$283.39	50	
12010975	6	FLAT	YES	\$213.41	50	
12020005	22	ROUND	YES	\$19.05	1	
12010852		SECONDARY LOCK		\$17.68	10	

WEATHER PACK SEALS AND CAVITY PLUG

PART NO.	WIRE SIZE	COLOUR	MATERIAL	TRADE PRICE PER PACK	PACK QTY	CODE
						C
12015899	1.29 - 2.06	RED	SILICON	\$94.29	100	
12015323	2.03 - 2.80	GREEN	SILICON	\$82.19	100	
12010293	2.81 - 3.49	GREY	SILICON	\$82.19	100	
12015193	3.50 - 4.21	BLUE	SILICON	\$92.93	100	
12010300	CAVITY PLUG	GREEN	SILICON	\$98.15	100	

WEATHER PACK CONNECTOR MOUNTING CLIPS

PART NO.	TYPE	TRADE PRICE PER PACK	PACK QTY	CODE
				C
12045817	SPEED CLIP	\$12.23	10	
12059415	SCREW MOUNT	\$20.99	10	

Note: All prices in catalogue exclude GST.

CARROLL QUALITY GUARANTEED

COMPLETE WEATHER PACK CONNECTORS

Complete connectors consist of both housings and sufficient contacts to build two (2) connectors. Contacts and seals supplied suit 2mm² (4 mil auto).

PART NO.	POLES	TYPE	TRADE PRICE PER PACK	PACK QTY	CODE C
2C1CW	1	FLAT	\$21.37	2	
2C2CW	2	FLAT	\$21.81	2	
2C3CW	3	FLAT	\$31.57	2	
2C4CIW	4	FLAT	\$41.47	2	
2C4CSW	4	SQUARE	\$46.29	2	
2C5CW	5	FLAT	\$65.38	2	
2C6CW	6	FLAT	\$57.38	2	
1C22CW	22	ROUND	\$170.35	1	

FUEL INJECTION/REGULATOR CONNECTOR

Two, three and four circuit housings complete with contacts and rubber boot for sealing, in convenient packaged presentation. Components are available outside of kit form in bulk.

COMPLETE CONNECTOR KITS

PART NO.	NO. OF CIRCUITS	TRADE PRICE PER PACK	PACK QTY	CODE C
BRP1	2	\$13.94	1	
BRP3	3	\$57.52	1	
BRP4	4	\$31.52	1	

COMPONENTS

PART NO.	DESCRIPTION	TRADE PRICE PER PACK	PACK QTY	CODE C
0-0925590	TERMINAL	\$42.33	100	
827551-3	2 CIRCUIT PLUG	\$139.09	50	
1280703026	2 CIRCUIT BOOT	\$66.99	10	
1-827578-1	3 CIRCUIT PLUG	\$114.02	10	
MT-4BV	4 CIRCUIT PLUG	\$85.47	10	
859G547-B	3 & 4 CIRCUIT BOOT	\$85.47	10	

TEMPERATURE SENDER CONNECTOR

Single circuit housing with cutaway area for mounting onto sender units complete with correct terminal contact that features sprung mating nib. 10 of each terminal and housing in each kit. Components are available outside of kit form in bulk.

COMPLETE KIT

PART NO.	DESCRIPTION	TRADE PRICE PER PACK	PACK QTY	CODE C
TS KIT	TEMPERATURE SENDER KIT	\$23.61	10	

COMPONENTS

PART NO.	DESCRIPTION	TRADE PRICE PER PACK	PACK QTY	CODE C
2962965	HOUSING	\$36.28	50	
605001BL2	TERMINAL	\$35.58	100	

COMPLETE CONNECTOR KITS BRP1



COMPLETE CONNECTOR KITS BRP3



COMPLETE CONNECTOR KITS BRP4



TEMPERATURE SENDER HOUSING 2962965

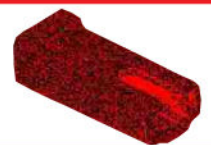

TEMPERATURE SENDER TERMINAL 605001BL2



Note: All prices in catalogue exclude GST.

SALES ENQUIRIES FREE FAX: 1800 654 325